

DISCLAIMER
 THIS DRAWING WAS PREPARED EXCLUSIVELY FOR TOM GONZALES AND ACCURATELY REPRESENTS TO THE BEST OF OUR KNOWLEDGE, THE MATTERS CONTAINED HEREIN AS OF THE DATE STATED HEREON. THIS DRAWING MAY NOT BE RELIED UPON BY ANY OTHER PERSON OR ENTITY FOR ANY PURPOSE WHATSOEVER.

Kenneth F. Barrow
 LAND SURVEYOR
 DATE 6-4-10

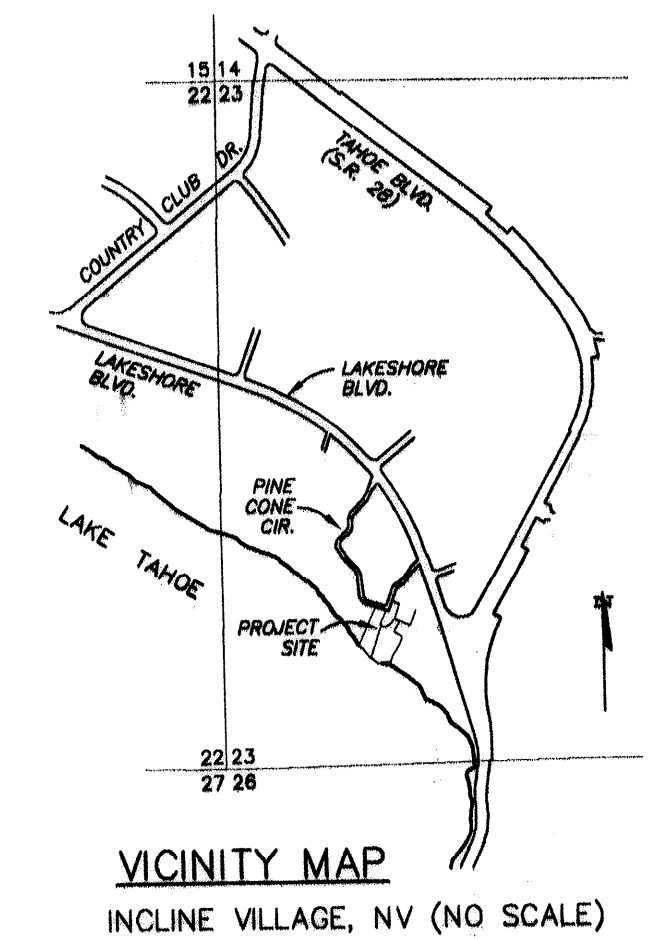

DRAFT

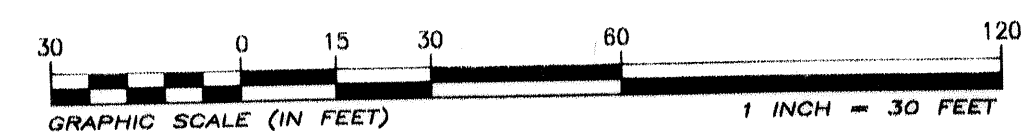
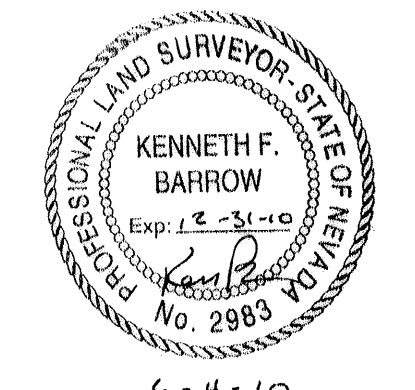

KENNETH F. BARROW P.L.S.
 LAND SURVEYOR
 P.O. DRAWER 7000 INCLINE VILLAGE NEVADA 89450
 775 - 831 - 1701 FAX 775 - 831 - 1766

AS-BUILT CONTOUR & BATHYMETRIC SURVEY
 LOT 18A, LOT D-1A & PAR. 1, RECORD OF SURVEY 4252, & LOT C, PARCEL MAP 172
 INCLINE VILLAGE, WASHOE COUNTY, NEVADA
 A.P.N.s 130-241-56 & 130-312-(28,27,04) 1675/1685 PINE CONE CIR. & 1135/1137 LAKESHORE BLVD.

SCALE	AS NOTED
DATE	07 MAY 2010
DRAWN	RBL
APPROVED	KFB
REVISED	6-4-10
JOB NO.	005-10C